

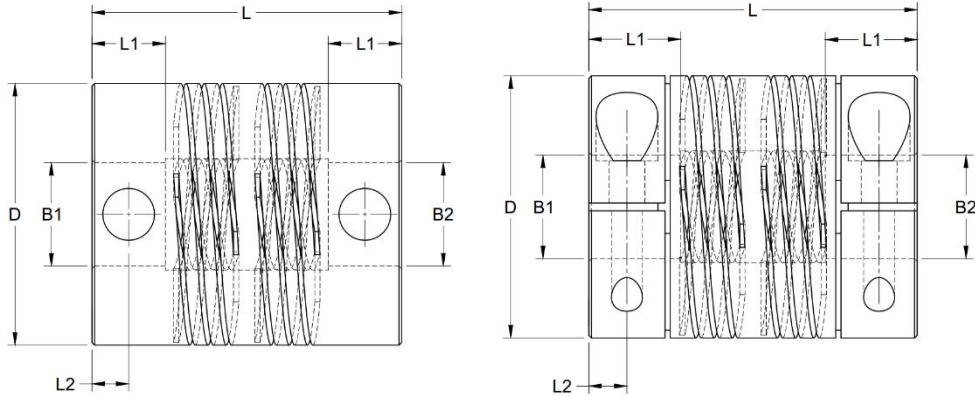

## BUDGET BEAM COUPLING



| Series Number    | Outside Diameter (D) (mm) | Length (L) (mm) | Attachment         | Screw Size   | Bore Combination (B1 & B2)      | Bore Depth (L1) (mm) | Screw Position (L2) (mm) |
|------------------|---------------------------|-----------------|--------------------|--------------|---------------------------------|----------------------|--------------------------|
| BBC050<br>BBS050 | 12.6                      | 19.1<br>14.0    | Clamp<br>Set Screw | M1.6<br>M2.5 | 3mm-3mm                         | 6.1<br>3.7           | 1.5                      |
| BBC075<br>BBS075 | 18.9                      | 22.9<br>21.6    | Clamp<br>Set Screw | M2.5<br>M4   | 4mm-4mm<br>5mm-5mm<br>6mm-6mm   | 6.4<br>6.3           | 2.9<br>3.2               |
| BBC100<br>BBS100 | 25.3                      | 31.8<br>30.0    | Clamp<br>Set Screw | M3<br>M5     | 6mm-6mm<br>8mm-8mm<br>10mm-10mm | 8.9<br>7.1           | 3.7<br>3.6               |
| BBC125<br>BBS125 | 31.6                      | 38.1<br>31.8    | Clamp<br>Set Screw | M4<br>M6     | 10mm-10mm<br>12mm-12mm          | 11.2<br>7.6          | 4.6<br>3.8               |

| Series Number    | Outside Diameter (mm) | Misalignment  |               |            | Bore Combination | Torque (Nm) | Torsional Stiffness (deg/Nm) |
|------------------|-----------------------|---------------|---------------|------------|------------------|-------------|------------------------------|
|                  |                       | Angular (deg) | Parallel (mm) | Axial (mm) |                  |             |                              |
| BBC050<br>BBS050 | 12.6                  | 3             | 0.07          | ±0.13      | 3mm-3mm          | 0.92        | 5.90                         |
| BBC075<br>BBS075 | 18.9                  | 5             | 0.15          | ±0.25      | 4mm-4mm          | 5.50        | 1.15                         |
|                  |                       |               |               |            | 5mm-5mm          | 4.63        | 1.57                         |
|                  |                       |               |               |            | 6mm-6mm          | 3.95        | 2.09                         |
| BBC100<br>BBS100 | 25.3                  | 7             | 0.20          | ±0.50      | 6mm-6mm          | 8.59        | 0.65                         |
|                  |                       |               |               |            | 8mm-8mm          | 8.25        | 0.79                         |
|                  |                       |               |               |            | 10mm-10mm        | 7.57        | 0.95                         |
| BBC125<br>BBS125 | 31.6                  | 7             | 0.25          | ±0.50      | 10mm-10mm        | 10.96       | 0.47                         |
|                  |                       |               |               |            | 12mm-12mm        | 10.28       | 0.57                         |

Other bore combinations available upon request.

### Basic Model Number

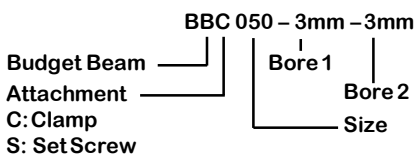

Material: Aluminum  
Finish: Blue Anodized

- Maximum recommended value to be applied with hex wrench in good condition.
- Listed Torque is the “static” value. Customer to determine a safety factor suitable for their application.